



PERSONAL CARE | HEALTHCARE
MEMORY SUPPORT

At the center of wellbeing

WELCOME TO LANDIS HOMES



PERSONAL CARE

Personal Care households (Aspen, Birch, and Cedar) encourage independence and provide limited assistance and support. This assistance includes nursing oversight and management of physical, social, spiritual and emotional needs. Several levels of Personal Care are available and priced according to the degree of support needed. Personal Care, for persons who require a secured memory support household, is offered in Lititz House.

Features included in the daily fee

- Standard, large or apartment-style residences
 - All Meals
 - Housekeeping, Laundry & General Maintenance services
 - Utilities, including cable television and internet service
 - Assistance with activities of daily living, as needed
 - Pastoral Services
 - Social & Recreational Activities, Wellness
 - Priority Access to Healthcare
 - Social Services
 - Nursing oversight & management
- Telephone service is an additional charge*

HEALTHCARE

Healthcare households (Conestoga, Lititz, Lancaster, Oregon, Manheim, and Ephrata) are for persons requiring 24-hour care and supervision under the direction of a physician. Healthcare rooms are located within close proximity to dining rooms, activity areas, living rooms, rehabilitation services, and a chapel. Healthcare offers rehabilitation after surgery or illness, as well as extended care when ongoing assistance is needed. An individualized care plan is prepared for each resident, with input from the resident, nursing, social services, pastoral services, life enrichment, dining services, family members, and the provider. Residents have access to on-site physical, speech, and occupational therapies as ordered by a practitioner. Healthcare for persons in need of memory support is offered in Lancaster House.

Features included in the daily fee

- Private room with private or shared bath
 - Nursing Care
 - All Meals
 - Housekeeping, Laundry and General Maintenance services
 - Utilities, including cable television and internet service
 - Social Services
 - Pastoral Services
 - Social & Recreational Activities
- Telephone service is an additional charge*

MEMORY SUPPORT

Our specially trained team nurtures residents through individual programming in a secure setting. These secured dementia care areas are designed to minimize noise and distractions. Each living area includes a country kitchen, dining area, living room, and family room. Enclosed courtyards allow residents to enjoy the outdoors and to take part in activities such as picnics, lawn games, gardening, and other outdoor events.

- Memory Support in Healthcare is located in Lancaster House, with 11 private rooms and two private rooms with shared bath.
- Memory Support in Personal Care offers all private rooms in Lititz House.

PERSONAL CARE *Floor Plan Gallery*

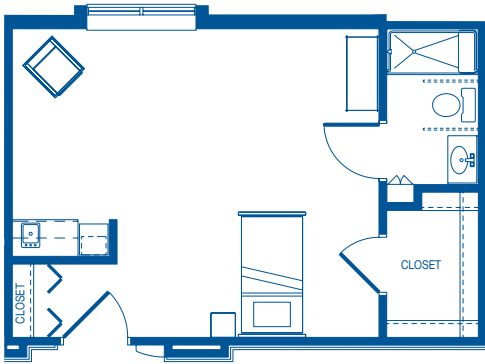

■ Large Room

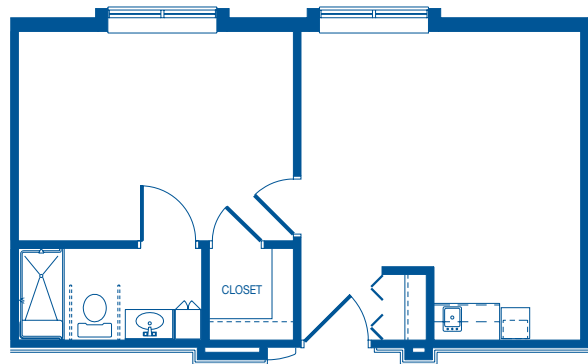

■ One Bedroom Apartment

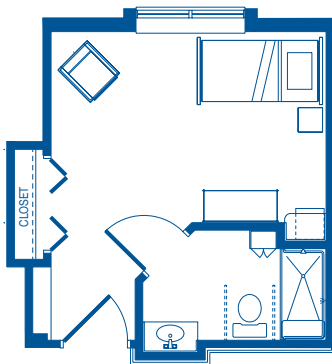

■ Standard Room

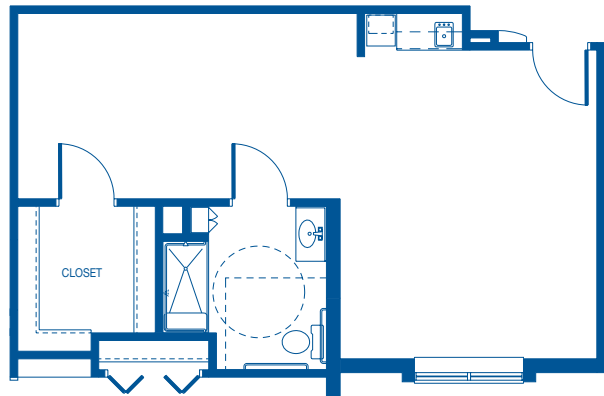

■ Studio Apartment

HEALTHCARE *Floor Plan Gallery*

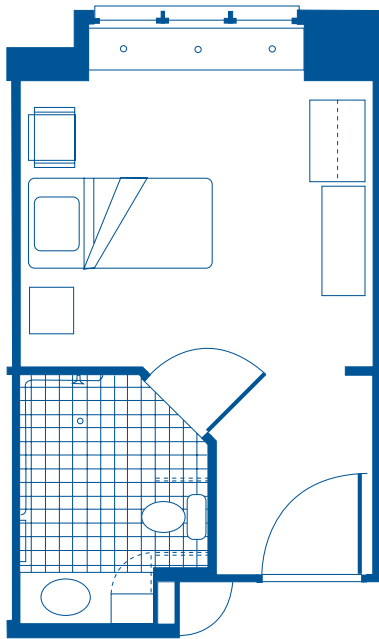

■ Healthcare with Private Bath

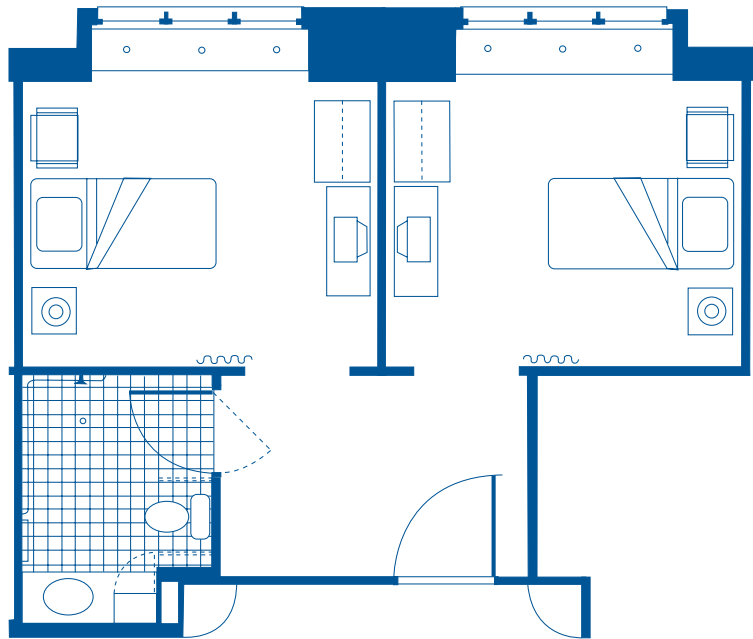

■ Healthcare with Shared Bath

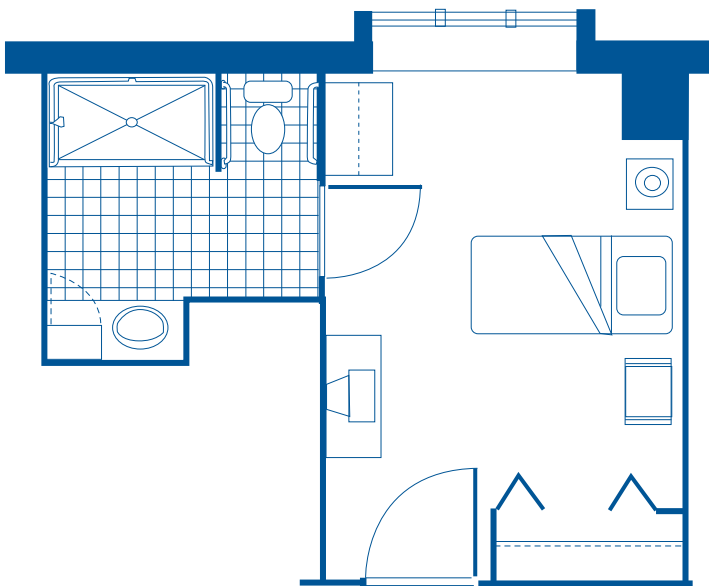

■ Ephrata House



APPLICATION PROCESS – 3 Easy Steps

STEP 1 Prospective residents and their family are encouraged to visit Landis Homes, for a personal visit. The Admissions Team will discuss the services and programs available at Landis Homes as well as the fees

Appointments may be made by contacting:

PERSONAL CARE AND HEALTHCARE ADMISSIONS

To discuss: Personal Care, Memory Support, Healthcare and Rehabilitation Care
717.381.3548 | fax 717.581.3996
admissions@landis.org

STEP 2 There is no fee required to submit an Application for Residency. Completed applications are reviewed by Landis Homes for approval. Approved applicants names are added to the future resident list. Applicants may bypass the future resident list in situations where there is immediate availability.

STEP 3 When an accommodation becomes available, the prospective resident will be contacted and arrangements made to determine that the applicant continues to qualify financially and is able to meet the essential requirements for residency. The Admissions Team personnel can assist applicants with the details regarding the move process.



Landis Homes complies with all federal, state and local Fair Housing laws and does not discriminate against any applicant seeking admission on the basis of race, religion, national origin, sex, ancestry, color, disability or handicap. However, if the applications for admission are in excess of the facilities available, qualified applicants are placed on a waiting list.





RATES

Daily Rates Per Person | Effective July 2022

PERSONAL CARE SUITES	Base	Intermediate	Enhanced
Standard	\$267	\$302	\$345
Large, occupied by two persons	\$257	\$292	\$335
Large, occupied by single person	\$364	\$399	\$442
Apartment, occupied by two persons	\$266	\$301	\$344
Apartment, occupied by single person	\$380	\$415	\$458

PERSONAL CARE SUITES, MEMORY SUPPORT	Base	Enhanced
Standard	\$393	\$401
Respite Rates – Additional \$20		

HEALTHCARE	Regular	Memory Support
Private Room	\$569	\$587
Private Room with Shared Bath	\$546	\$564





Landis Homes

LandisHomes.org

1001 East Oregon Rd
Lititz, PA 17543
717.569.3271

**PERSONAL CARE,
HEALTHCARE AND MEMORY
SUPPORT ADMISSIONS**

717.381.3548 | fax 717.581.3996
admissions@landis.org

